

PC-2

PASSAGE CONVEYOR

通道型運輸帶

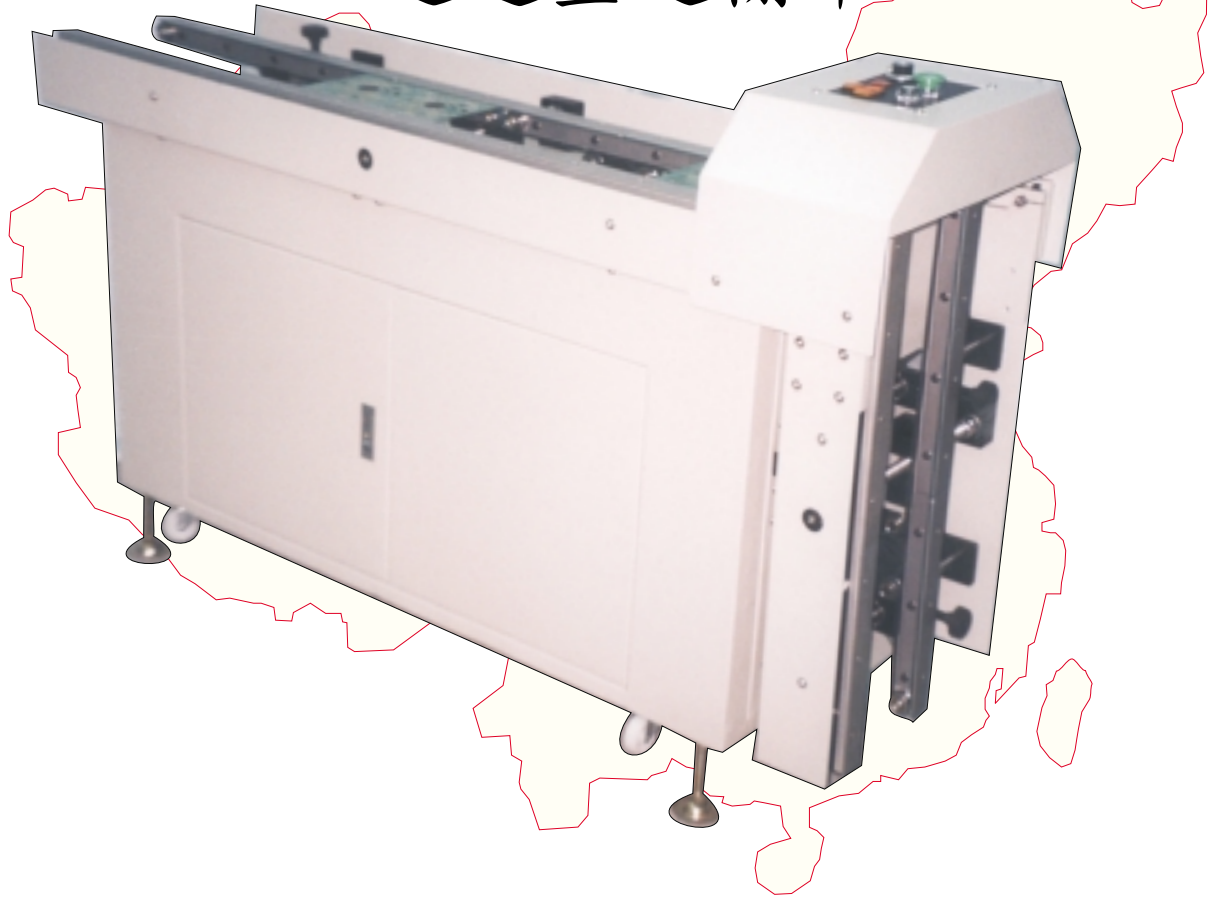

CHARACTERISTICS

- * Totally two configurations are available.
- * Rigid structure by use of toggle levers to the gate.
- * Smooth up/down motion of the gate actuated by pneumatic cylinder.
- * Parallelism of the conveyor can be kept within 0.5/1000mm.
- * Multiple board stops can be added to improve productivity.
- * Adoption of PLC allows ease of future expansion or modification.
- * Compatible with SMEMA or contact type machine interface.
- * Use of low voltage electrical devices for safety operation.
- * Suitable for Auto or Manual Insertion and SMT lines.
- * Reversible board transfer function provides flexible connection.
- * Self-diagnostic function supervises board-jamming problem.
- * Conveyor belt can stop automatically when conveyor is idle.

特點

- * 兩款送板結構可供選擇.
- * 活門由槓桿支撐,結構鞏固.
- * 氣缸推動之活門開關柔順.
- * 運輸帶之平行度為 0.5/1000mm.
- * 可多加儲板位置,提升生產力.
- * PLC 控制,擴展及更改更容易.
- * 適用於 SMEMA 標準及接點式通信.
- * 全部電器元件皆以 DC24V 或以下操作,確保安全.
- * 適用於 AI, MI 及 SMT 流水線.
- * 可選擇送板方向.
- * 自我監察送板順暢程式.
- * 等候時運輸帶自動停止.

CONFIGURATIONS 結構

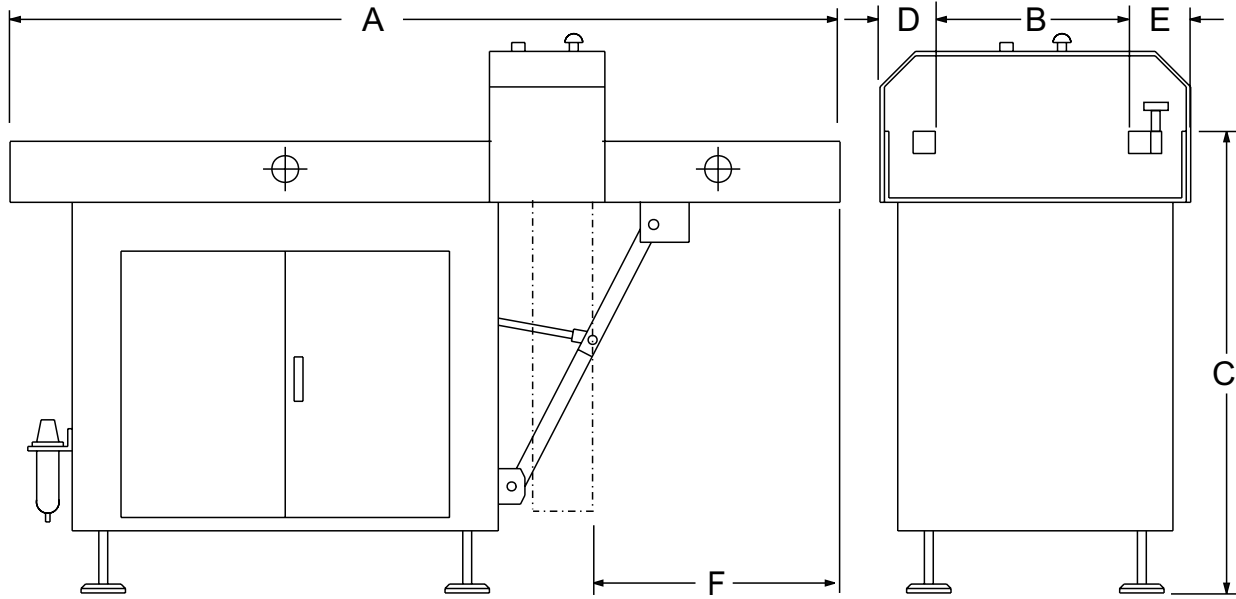
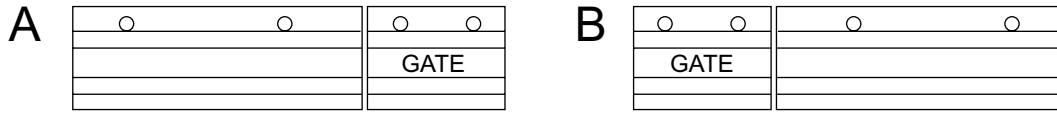

SPECIFICATION	規格		
Configuration	結構	A / B	
A		mm	≥ 1500
B Board width	基板寬度	mm	25~250/355
C		mm	735~790 880~935 930~985
Board transfer direction	送板方向		← / →
Adjustable transfer speed	可調速度	mm/sec	120~280 240~600
No. of buffers	儲板數量		≥ 2
Edge clearance	承托基板寬度	mm	3.5/4.5
No. of sensors	電眼數量		≥ 3
Power supply	電源	vac	110/220
Air pressure	壓縮氣壓	bar	4~6
D		mm	75
E		mm	135
F		mm	580



SMartop Technology Limited

創盛科技有限公司

Flat B, 9/F., Wing Yip Ind. Bldg., 21-27 Wing Yip St.,
Kwai Chung, N.T., Hong Kong.

香港辦事處：Tel : (852) 2790 4433/2790 4438

Fax : (852) 2790 5918

Email : sales@smartop.com.hk

中國辦事處：Tel : 86-769-556 1321/86-769-556 5921

Fax : 86-769-556 7183

Email : sales.dg@smartop.com.hk

